

DE Der Aufbau muß von Erwachsenen durchgeführt werden, nach dem Zusammenbau ist eine Endkontrolle durchzuführen! Nach ca. 14 Tagen sollen die Schrauben nachgezogen werden.

AT

CH

IE Adult assembly is required; check before use! Retighten the screws after ca. 14 days.

GB

FR L'assemblage doit être assuré par un adulte. Vérifier avant l'emploi. Après environ 14 jours revisser.

NL Montage dient te gebeuren door volwassenen; controleren voor gebruik. Na ca. 14 dagen moeten de schroeven nogmaals aangedraaid worden.

HU A felépítést felnőtteknek kell végrehajtania, az összeszerelés után végso ellenőrzést kell végezni! Kb. 14 nap múlva a csavarokat után kell húzni.

IT Adulti requesti per controllo dell' assemblaggio. Controllare prima dell'uso. Dopo ca. 14 giorni si prega di riavitare i bulloni.

DK Skal opstilles af en voksen. Efter samling skal der gennemføres en slutkontrol! Efter ca. 14 dage skal skruerne spændes efter.

Montaż winna przeprowadzać osoba dorosła, po złożeniu należy przeprowadzić weryfikację! Po upływie ok. Dwóch tygodni należy dokręcić śruby.

ca. B 82 x T 60 x H 130 CM

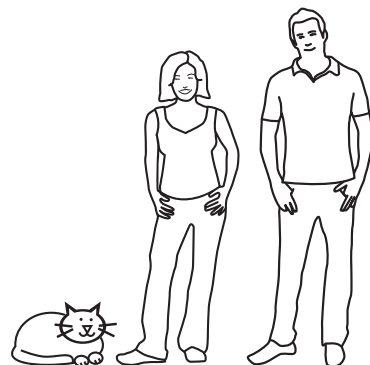

2 x S1

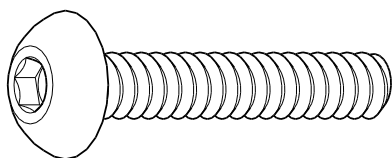

3 x S2

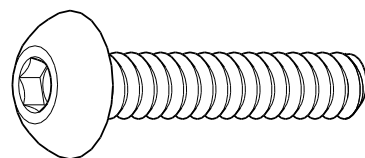

4 x S3

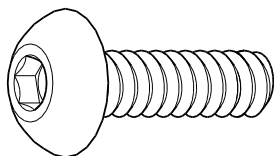

2 x S4

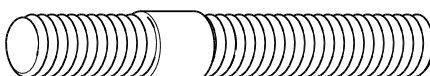

4 x S5



4 x S6

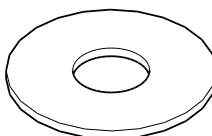

4 x S7

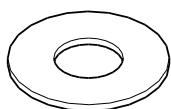

1 x S8

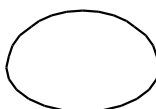

Ax4



Bx1

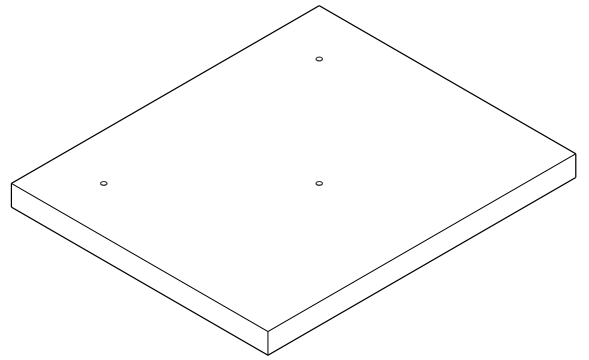

Cx6

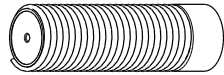

Dx1

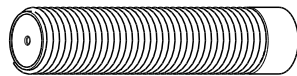

Ex1

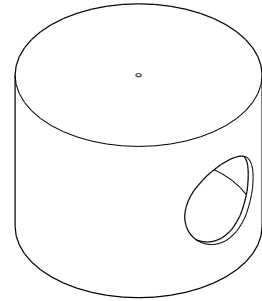

Fx1

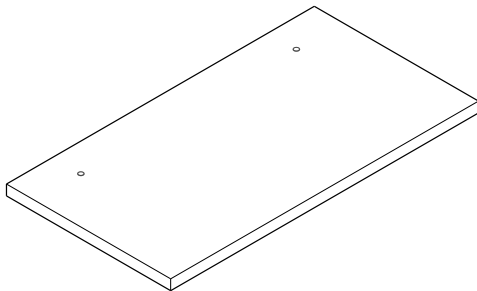

Gx1

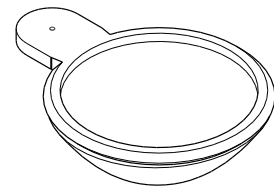

Hx1

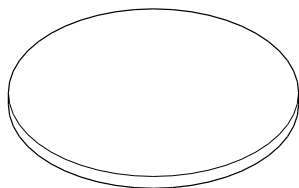

Ix1

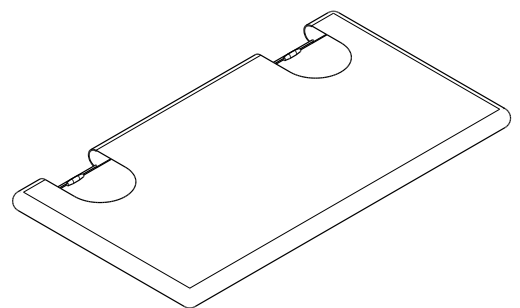

Jx1

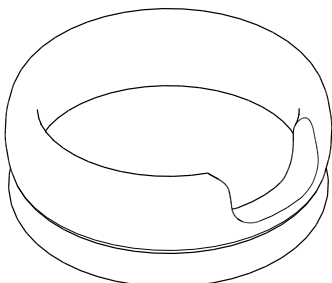

Kx1

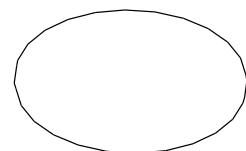

1

4 x S3

4 x S7

A x 4

B x 1

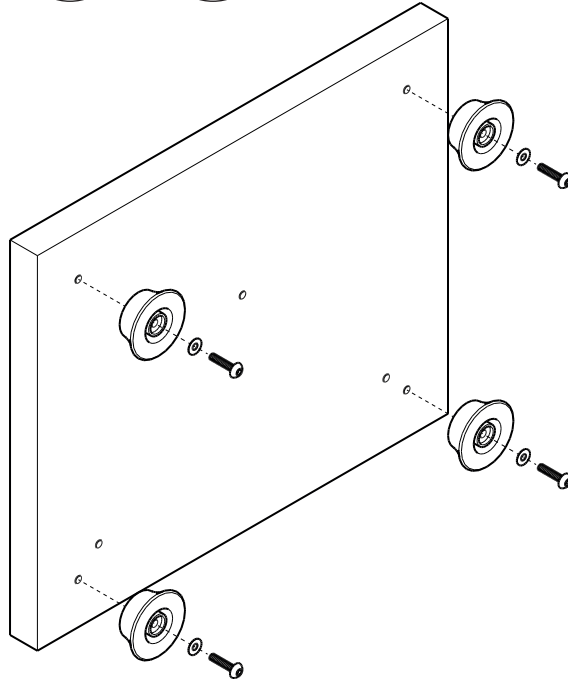

2

2 x S1

2 x S6

C x 2

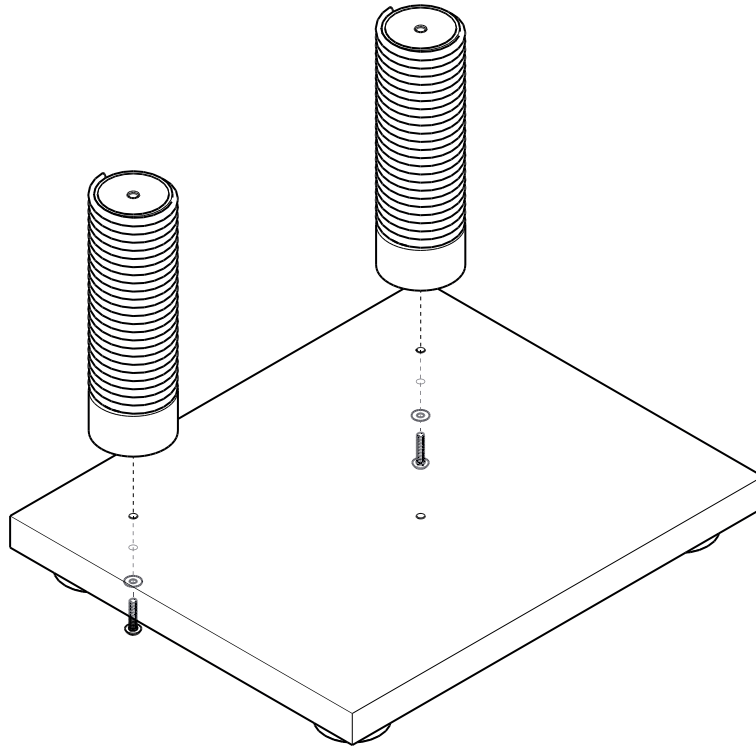

3

1 x S2

1 x S6

E x 1

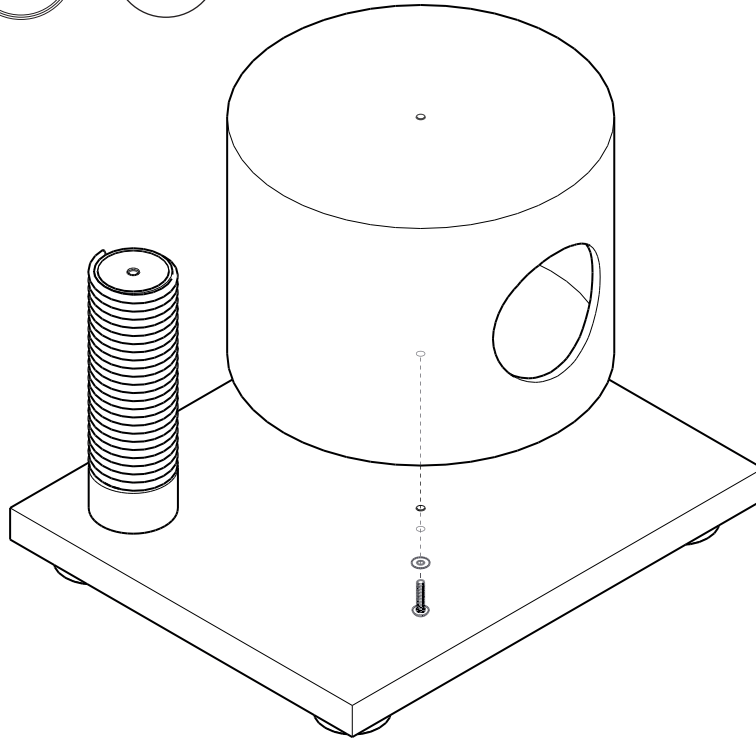

4

2 x S5

C x 2

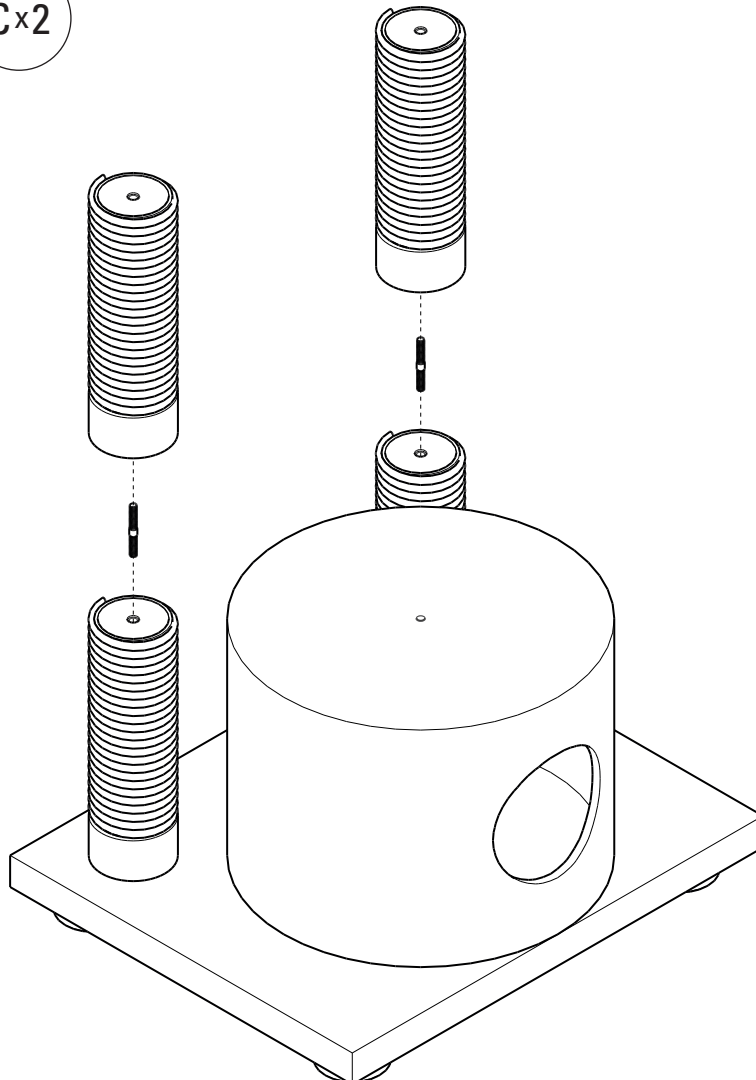

5

1 x S4

Cx1

Fx1

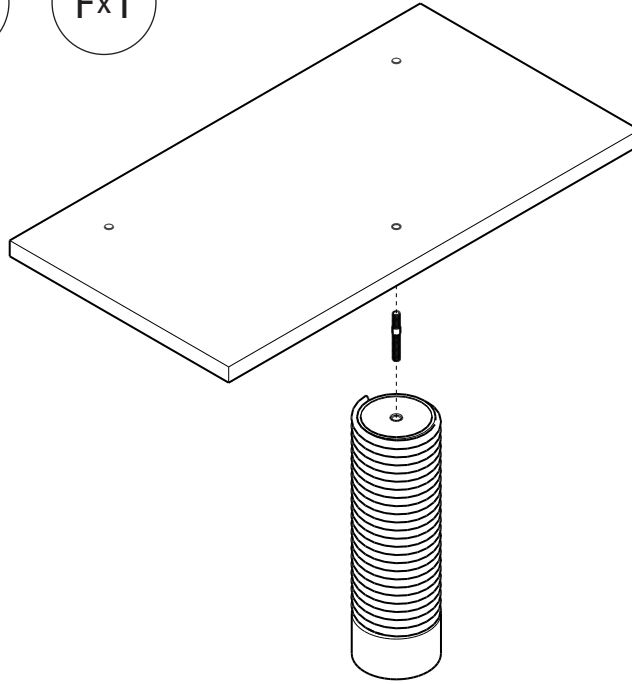

6

1 x S2

1 x S6

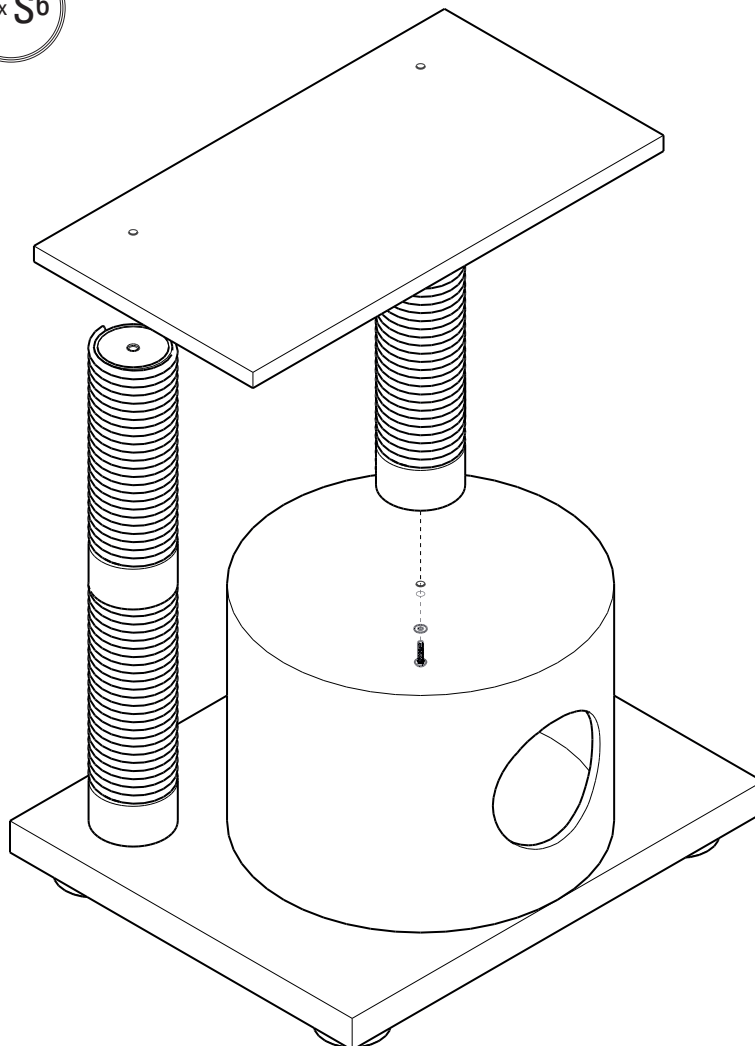

7

2 x S5

Cx1

Dx1

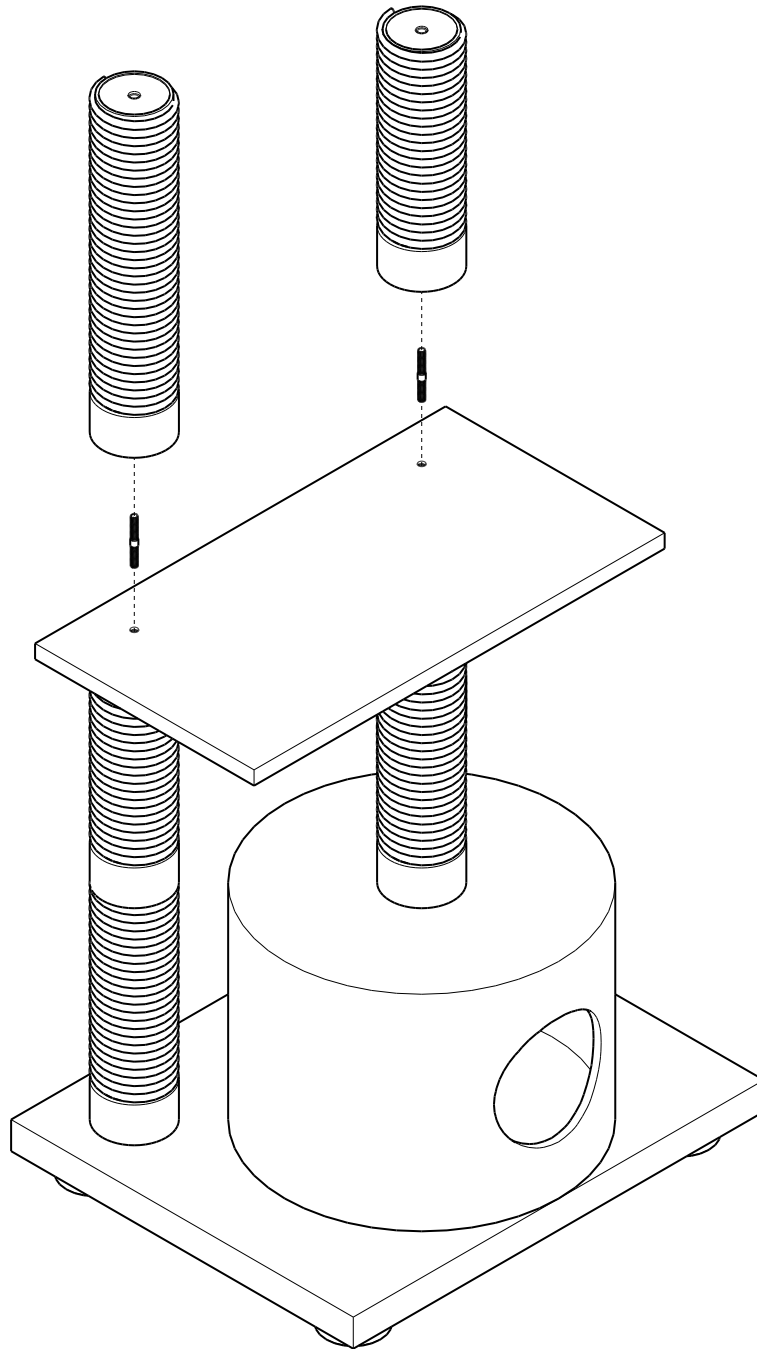

8

1 x S2

1 x S8

Gx1

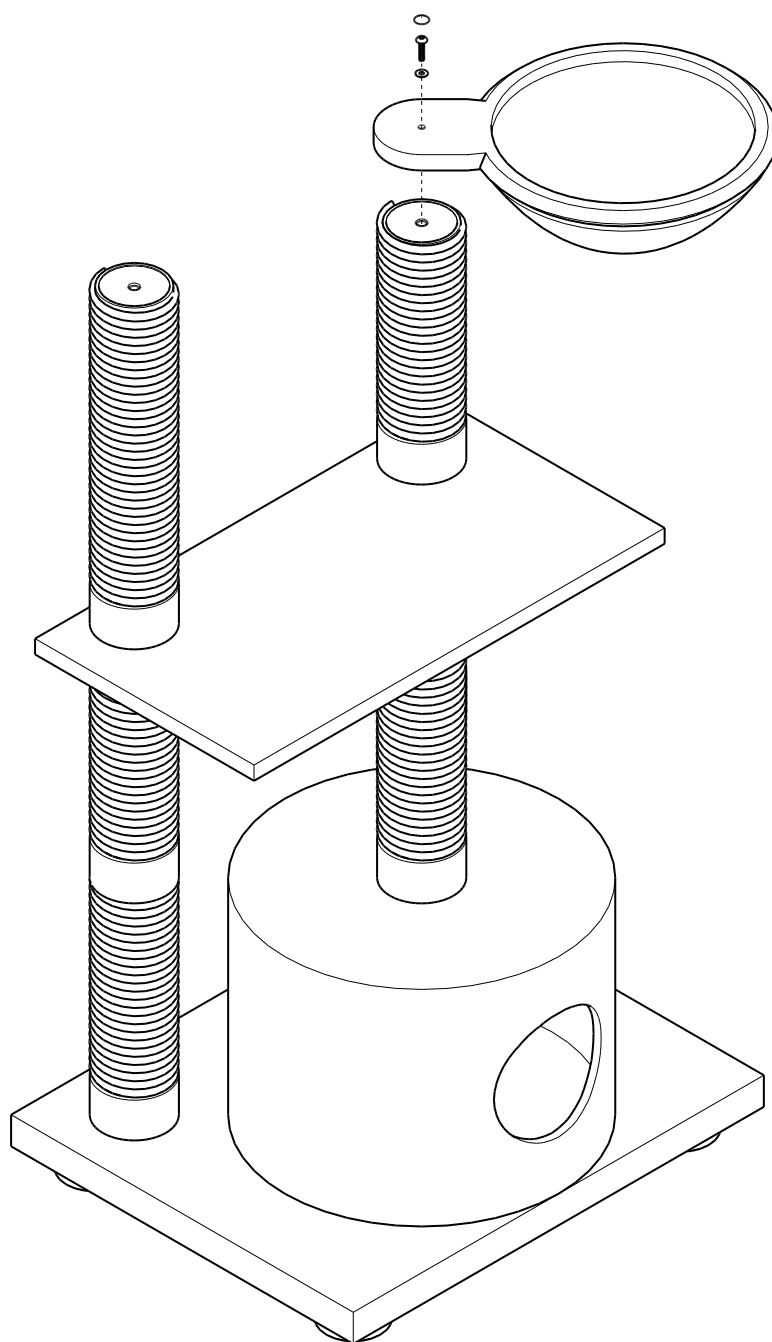

9

1 x S4

H x 1

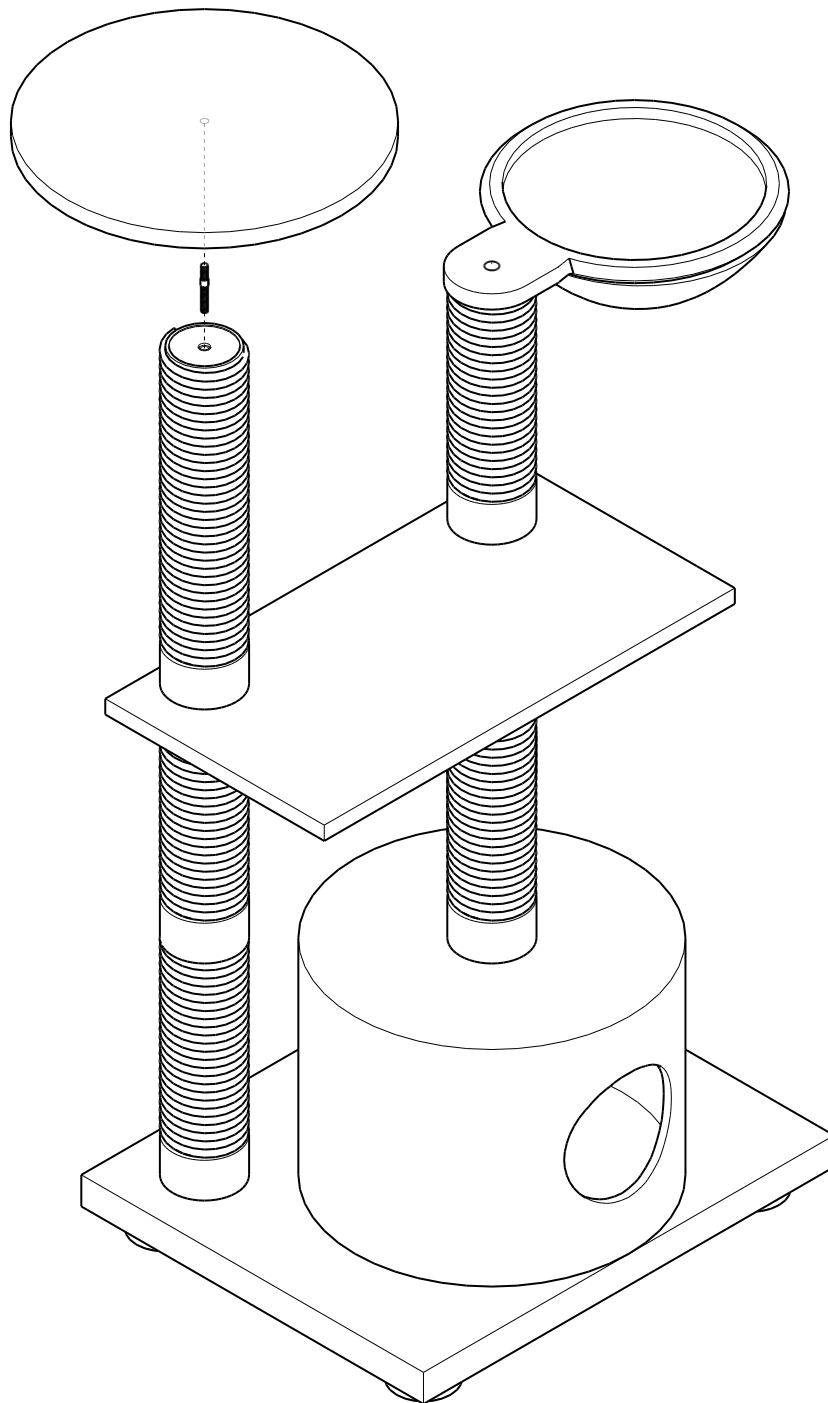

10 1x1

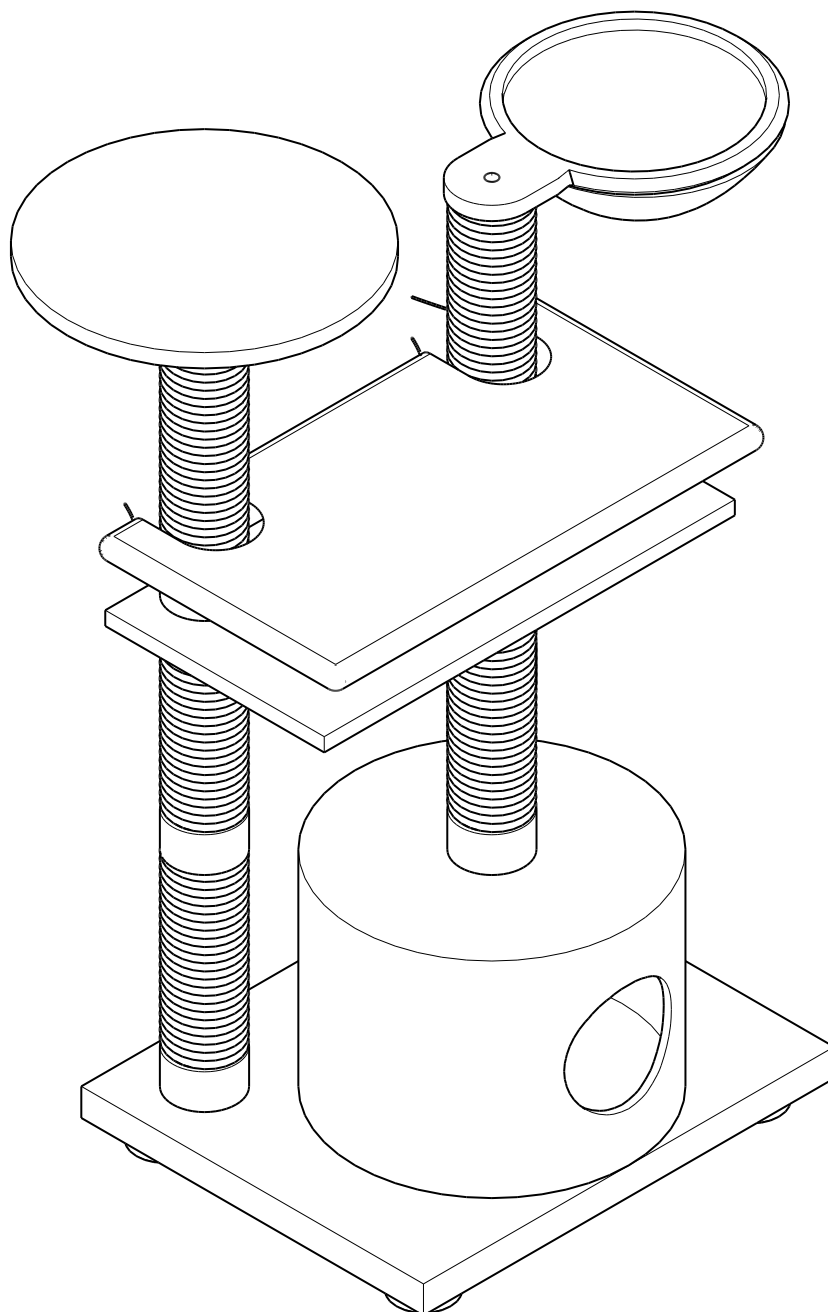

11

Jx1

Kx1

